



## SEAMLESS, UNIFORM ILLUMINATION

Architectural Luminous Ceiling System

### SYSTEM OVERVIEW

StretchLume is a high-performance luminous ceiling system combining high efficacy LED light sources with precision-engineered stretch membranes to create seamless, uniformly illuminated surfaces.

The system delivers a continuous, shadow-free finish with no visible hotspots - ideal for projects requiring clean integration, consistent light quality, and a premium architectural aesthetic.

### KEY FEATURES

- ✓ High efficacy 24v lighting options
- ✓ Uniform light distribution with no hotspots
- ✓ Lightweight construction
- ✓ Compatible with intelligent lighting controls
- ✓ Flexible installation methods

### TYPICAL SYSTEM BUILD UP

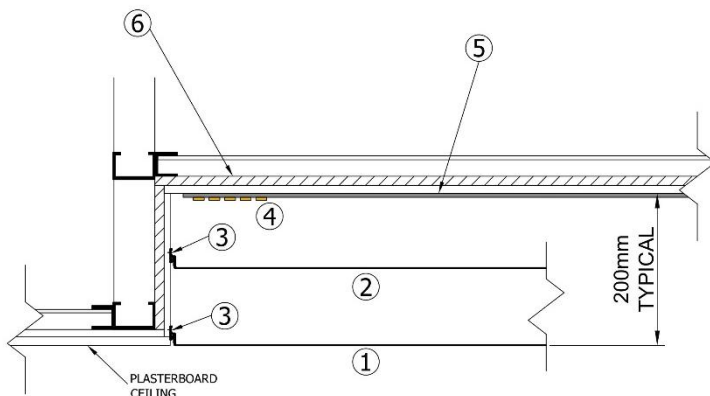

- ① Stretch Diffuser Membrane
- ② Optional Protective Membrane
- ③ Perimeter Track / Profile System
- ④ LED light source (LED sheet or strip)
- ⑤ Plasterboard Upstand/Soffit Painted White
- ⑥ Ply lining within plasterboard sides and top

## PERFORMANCE CHARACTERISTICS



### LIGHT QUALITY

Uniform diffusion across full surface with no visible hotspots



### SYSTEM DEPTH

Optimum depth 200mm depending on lighting configuration and requirements (minimum depth 60mm)



### MEMBRANE

Translucent stretch membrane providing a smooth consistent finish



### FIRE PERFORMANCE

Tested to Bs1d0  
No contribution to spread of flame



### MAINTENANCE

Removable membrane for access to services. Cleanable surface

## INTEGRATION & COMPATIBILITY



Compatible with LED strip and LED light sheet systems



Downlights, feature lighting and linear lighting



HVAC grilles and building services integration



Access panels/hatches



Control systems compatible:

- Casambi
- DALI
- 0-10V
- DMX

## INSTALLATION METHODS



### FLUSH MOUNT

Integrated within a formed ceiling opening/recess - flush or inset



### SURFACE MOUNT

Fixed directly to the ceiling/soffit, providing a clean, luminous panel



### SUSPENDED

Creates a floating luminous feature supported by wires/rods

## APPLICATIONS

- Commercial offices
- Retail environments
- Hospitality and leisure
- High-end residential
- Feature Ceilings

## SPECIFICATION SUPPORT

- NBS specifications  
<https://nbs.fyi/EIMYy4>
- CAD details & technical drawings
- Lighting layout guidance
- Technical/design consultation

## MANUFACTURER

Imperial Stretch Ceilings  
Unit 21-22  
Space Business Centre  
Wokingham  
RG41 2PQ  
01189 072906  
hello@imperial-is.co.uk  
www.imperial-is.co.uk